

GABION G1. 1,00x1,00x13,00  
Sc: 1:50

GABION G2. 1,00x2,00x13,00  
Sc: 1:50

SECȚIUNE TRANSVERSALĂ PINTEN  
Sc: 1:50

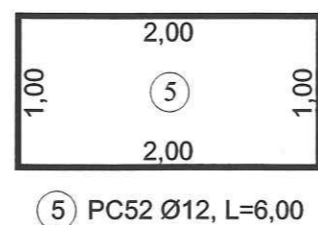
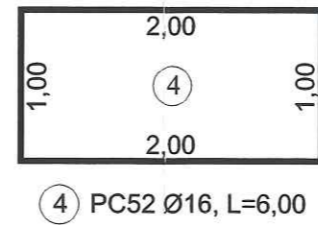
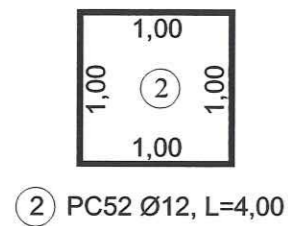
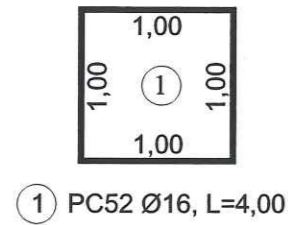
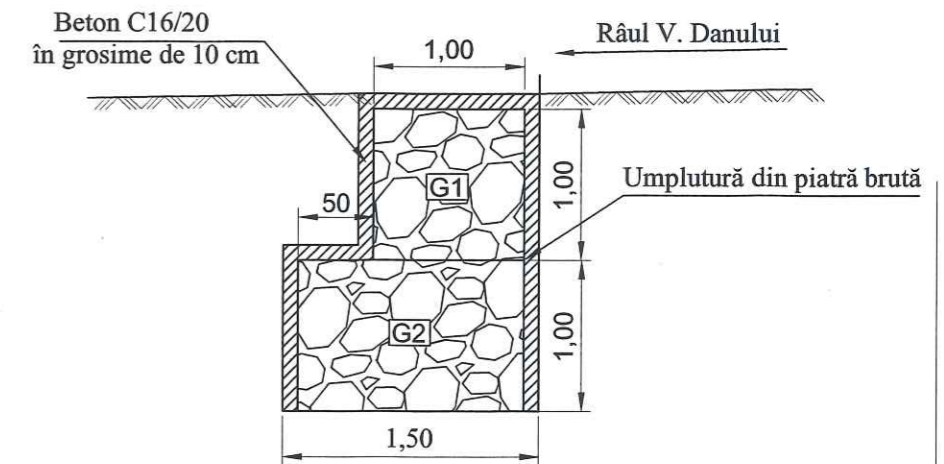

EXTRAS DE MATERIALE PENTRU  
GABIOANE - PINTEN AVAL

Marca	Ø	L	n	PC52 n x L		Piatra bruta (mc)	Plasa de sarma (mp)	Sudura in puncte (pct.)	Cofraj (mp)	Beton C16/20 (mc)
				12	16					
1	16	4,00	2		8,00					
2	12	4,00	12	48,00						
3	16	13,00	4		52,00					
Total corp gabion G1				48,00	60,00	13,00	54,00	70	26,00	3,90
4	16	5,00	2		10,00					
5	12	5,00	12	60,00						
6	16	13,00	4		52,00					
Total corp gabion G2				60,00	62,00	19,50	68,00	70	28,60	3,51
TOTAL LUNGIME PE Ø				108,00	122,00					
MASA PE Ø/ml				0,888	1,580					
TOTAL MASA PE Ø				95,90	192,76					
TOTAL GENERAL				288,66		32,50	122,00	140	54,60	7,41

NOTĂ:  
Etrierii gabioanelor și celelalte laturi ale armaturilor din gabioane se leaga prin puncte de sudura electrica.

SEF PROIECT,  
ing. M. Ursache



Ed.1 / Rev.0

<p><b>S.C. ALFRID S.R.L. PITESTI</b></p>		<p>„CONSTRUIRE POD DE ACCES PESTE RÂUL VALEA DANULUI PE DRUMUL TÂNASE CECILIA, SAT VALEA DANULUI, COMUNA VALEA DANULUI”</p> <p>beneficiar: UAT Comuna Valea Danului contract nr. 553 /21.12.2020</p>		<p>faza: S.F.</p>
PROIECTAT	ing. M. Ursache	<p>scara: 1:50</p>	<p>PINTEN AVAL DIN GABIOANE, Hf=2,00m, L=13m</p>	<p>planșa nr. 5</p>
TOPOMETRIE	ing. I. Floarea			
PR. CALCULATOR	ing. M. Ursache	<p>data: 2020</p>		
VERIFICAT	ing. D. Radu			